

JUMPER SLEEVE

Easy to Use Connector Tool

PCT-JS



Innovation for the Last Mile™

The Easiest and Most Reliable Way to Make an F-Connection

END TO END MANUFACTURING

The PCT-JS patented jumper sleeve creates a built-in tool for easy, hand tightened, reliable connections. This innovative jumper sleeve allows the proper amount of hand tightened torque with out damaging connections.*

Once the PCT-JS is installed onto a jumper, the clear design provides visibility to the connector.

- ✓ Flexible, oval design provides superior tool-less torque
- ✓ No over tightening
- ✓ Allows clear view of connector
- ✓ Easy to install
- ✓ PCT-made connectors, coaxial cable and jumpers
- ✓ Recommended for use with products able to tolerate 5-10 in lbs of torque
- ✓ US Patent Nos. 7837501 B2, 8065940 B2

Ordering Information

- PCT-JS Jumper Sleeve for TRS Connectors

Another Clearly Innovative Solution
by PCT International



US Patent Nos. 7837501 B2, 8065940 B2.

STAY INFORMED - FOLLOW US



Call +1.800.306.8948 for more information

2260 W Broadway Rd | Mesa AZ 85202-1898 | USA | pctinternational.com

PCT.DS.CONNJS.201401c
© 2009-2014 PCT International, Inc.
Specifications subject to change without notice.

Easy 1-2-3 Assembly and Use

1. Install the PCT-JS jumper sleeve onto a jumper assembly (connector that has been correctly compressed onto coaxial cable) by inserting the connector into the slotted end of the jumper sleeve. (see Figure 1)
2. PCT-JS is completely mounted when an audible "Click" is heard. (see Figure 2)
3. Install the PCT-JS jumper with jumper sleeve onto the unit by guiding the connector into the appropriate F-81 port and rotating the jumper sleeve clockwise until finger tight.* (see Figures 3 & 4)

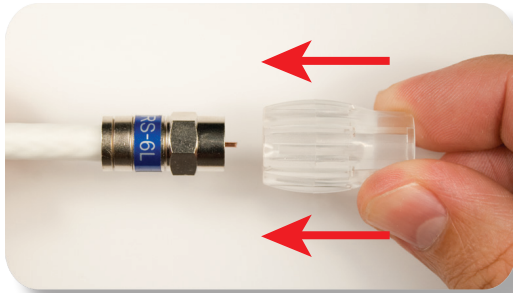

Figure 1



Figure 2

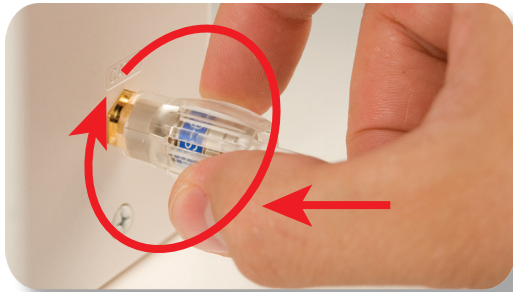

Figure 3

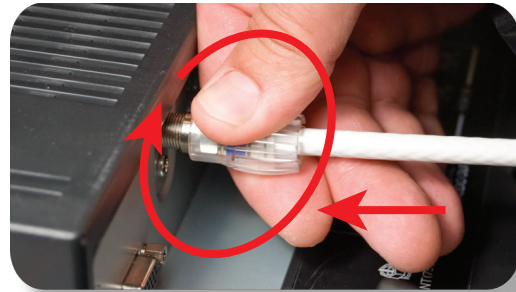

Figure 4



PCT-JS
Jumper Sleeve



PCT-JS
(shown installed onto PCT-JTRS6LA jumper)

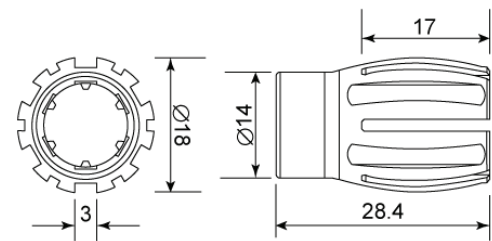

PCT-JS Dimensions
(mm)

Specifications

Parameters	Unit	PCT-JS
General		
Construction Material	--	Transparent Acrylonitrile Butadiene Styrene (ABS)
Operating Temperature Range	C / F	-40 to +60° / -40 to +140°
Used with Connector Types	--	F-Type Universal
Dimensions (W x H x D)	mm / in	28.4 x 18 mm / 0.093 x 0.059
Weight	g / oz	1.865 / 0.066

Note: * This product is only recommended for use with products able to tolerate 5 to 10 in lbs of torque.